

REV	DATE	DESCRIPTION	DRAWN

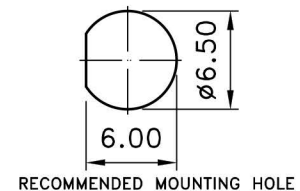
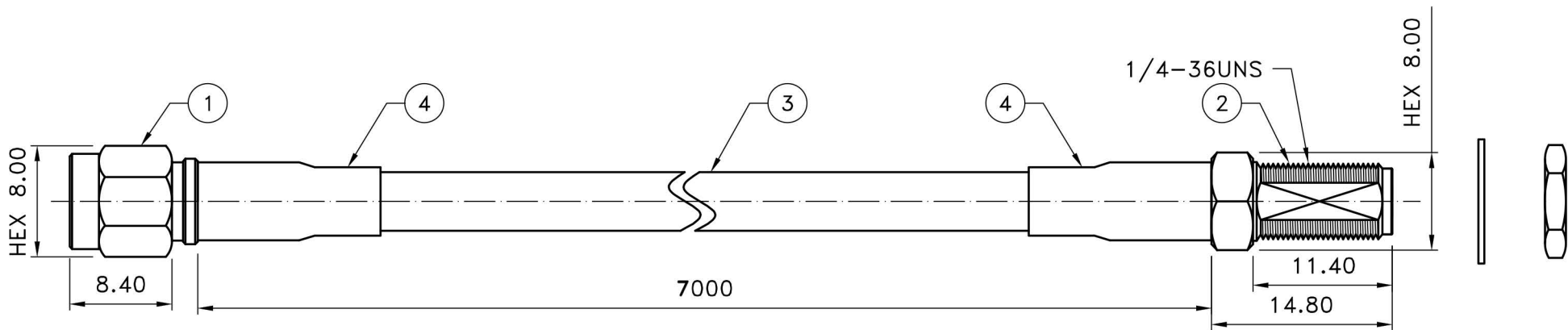

- NOTE:
- SMA MALE CRIMP
 CENTER PIN GOLD PLATING 20 μ THICK OVER NICKEL STRIKE
 BODY GOLD PLATING 3 μ THICK OVER NICKEL STRIKE
 BRASS AND PTFE PER SGS
 PTFE : TOMBO No.9002
 FINISH PLATING THICKNESS IN MICRO-INCHES
 COPPER PARTS AUTOMATIC CNC MANUFACTURING
 - SMA FEMALE BULKHEAD CRIMP
 CENTER PIN GOLD PLATING 20 μ THICK OVER NICKEL STRIKE
 BODY GOLD PLATING 3 μ THICK OVER NICKEL STRIKE
 BRASS AND PTFE PER SGS
 PTFE : TOMBO No.9002
 FINISH PLATING THICKNESS IN MICRO-INCHES
 COPPER PARTS AUTOMATIC CNC MANUFACTURING
 - LOW LOSS 200A COAXIAL CABLE/3D
 ATTENUATION : 0.32dB/m@900MHZ 0.42dB/m@1800MHZ 0.61dB/m@3000MHZ
 CONDUCTOR : BARE COPPER WIRE/Ø1.12mm
 INSULATION : GAS-FPE/Ø2.95mm
 TAPE : BONDED ALUMINUM FOIL
 SHIELD : TINNED COPPER WARE/16*4*0.10mm/59% COVERAGE
 JACKET : PVC/Ø4.95mm

Prohibit re-circulating

RoHS
COMPLIANT



NO	DESCRIPTION	MATERIAL	FINISH	Q'ty
4	D0176 (SHRINK TUBE)	PE	BLACK	2
3	LLC200	ASSY	BLACK	1
2	WL-SMA-2-BJ200	BRASS	GOLD	1
1	WL-SMA-1-200	BRASS	GOLD	1

NOTE	DIMENSION
1. STRIP ALL BURRS. 2. ALL DIMENSIONS ARE AFTER PLATING. 3. DIAMETERS ON COMMON CENTERS. TO BE CONCENTRIC WITHIN 0.1 T.I.R 4. CHAMFER 1ST & LAST THREADS 45° 5. BREAK ALL CONNERS & EDGES CO.15 MAX.	UNLESS OTHERWISE NOTED TOLERANCES 0.X=±0.2 0.XX=±0.1 CABLE LENGTH: L ≥ 10000 = + ⁵⁰ ₀ 1000 ≤ L < 10000 = + ³⁰ ₀ L < 1000 = + ⁸ ₀

TITLE SMA MALE-SMA FEMALE	
DRAWING NO. SMAP-SMAJB-200-7.0	
APPROVED	DRAWN DATE 05/23/17
CHECKED	SCALE 2:1
DRAWN ALICE	UNIT mm